

COFFEE MACHINE INSTRUCTIONS

咖啡机使用说明



1. Rinse, then fill the water tank with water.

清洗之后, 注入饮用水到水箱。



2. Press the Espresso or Lungo button to activate the machine.

按下「浓缩咖啡」或「大杯咖啡」按键以启动机器。



3. Blinking Lights: heating up (25 sec)

指示灯闪动: 加热中 (约25秒)

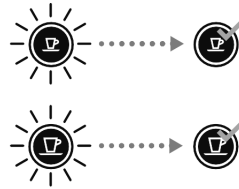

4. Steady Lights: ready

指示灯亮起: 已可操作



5. Lift the lever completely and insert a Nespresso capsule.

上拉拉杆, 放入一颗 Nespresso咖啡胶囊



6. Close the lever and place a cup under the coffee outlet.

下拉拉杆, 并将杯子放置在咖啡出口处



7. Press the Espresso (40 ml) or the Lungo (110 ml) button to start. Preparation will stop automatically. To stop the coffee flow or top up your coffee, press again.

按下「浓缩咖啡(40ml)」或「大杯咖啡(110ml)」按键以启动咖啡机。冲泡完毕咖啡机将自动停止如需增量或停止咖啡流出, 请再次按下同按键。



8. Remove the cup, lift and close the lever to eject the capsule into the used capsule container.

移开咖啡杯, 上拉拉杆, 已使用之咖啡胶囊将落入咖啡机内的回收盒中。

CAUTION: Never lift the lever during operation to avoid possible harm when operating the appliance.

注意: 基于安全考量, 切勿于咖啡机运作时上拉拉杆, 以免发生意外。